

Technical data sheet



Product features

Pasta cooker 7 l with drain tap

Model	SAP Code	00015019
--------------	-----------------	----------



- Basin volume [l]: 8
- Material: AISI 430
- Protection of controls: IPX4
- Maximum device temperature [°C]: 110
- Basket size [mm]: 1x 210 x 235 or 3x 138 x 100

SAP Code	00015019	Power electric [kW]	3.400
Net Width [mm]	270	Loading	230 V / 1N - 50 Hz
Net Depth [mm]	420	Basin volume [l]	8
Net Height [mm]	370	Basket size [mm]	1x 210 x 235 or 3x 138 x 100
Net Weight [kg]	9.00		

Technical data sheet



Technical drawing

Pasta cooker 7 l with drain tap

Model

SAP Code

00015019

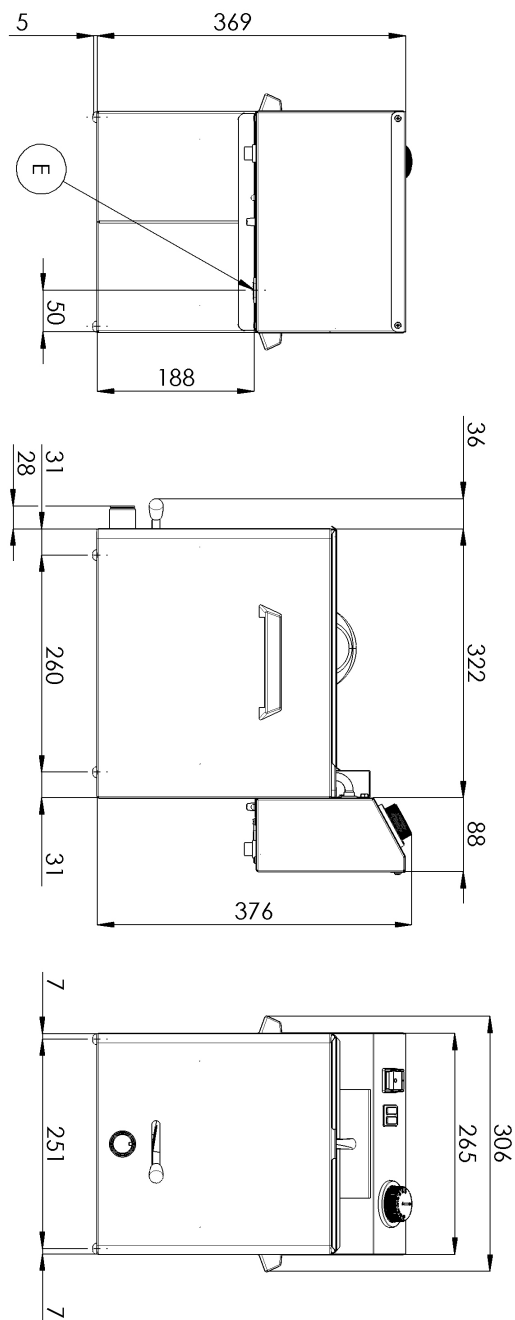

Technical data sheet



Technical parameters

Pasta cooker 7 l with drain tap

Model

SAP Code

00015019

1. SAP Code:

00015019

2. Net Width [mm]:

270

3. Net Depth [mm]:

420

4. Net Height [mm]:

370

5. Net Weight [kg]:

9.00

6. Gross Width [mm]:

310

7. Gross depth [mm]:

515

8. Gross Height [mm]:

440

9. Gross Weight [kg]:

10.00

10. Device type:

Electric unit

11. Construction type of device:

Table top

12. Power electric [kW]:

3,400

13. Loading:

230 V / 1N - 50 Hz

14. Protection of controls:

IPX4

15. Exterior color of the device:

Stainless steel

16. Material:

AISI 430

17. Indicators:

operation and warm-up

18. Basin volume [l]:

8

19. Maximum device temperature [°C]:

110

20. Minimum device temperature [°C]:

30

21. Additional information:

Baskets are not part of the delivery - can be purchased additionally

22. Basket size [mm]:

1x 210 x 235 or 3x 138 x 100